

T113ALR LIGATURE RESISTANT SHOWER PANEL WITH TIMED FLOW CONTROL, TEMPERATURE CONTROL AND VANDAL RESISTANT SHOWER HEAD

Includes integral HORNE Thermostatic Shower Valve pre-plumbed within a white powder coated aluminium panel with ligature resistant push button timed flow control, temperature control and vandal and ligature resistant shower head in chromium plated finish.



FEATURES & BENEFITS

- Durable painted panel and robust fittings ensure long lifespan
- Pressure tested pre-plumbed assembly
- Integral Horne TMV
- Fixed vandal & ligature resistant shower head
 - * Large area spray plate
 - * Two directional spray settings
- Integral 8 L/min flow regulator for water and energy conservation
- Ligature resistant push-button timed flow control for water and energy Conservation. Approx. duration 45 secs
- Highly suitable for retrofit applications
- Fast and easy installation
- Low level servicing valves for ease of maintenance
- Optional Accessory:
 - Pipe cover in same profile as panel



Dimensions in mm

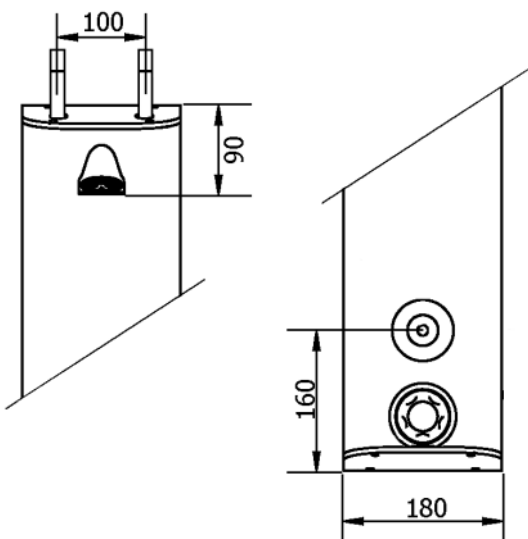
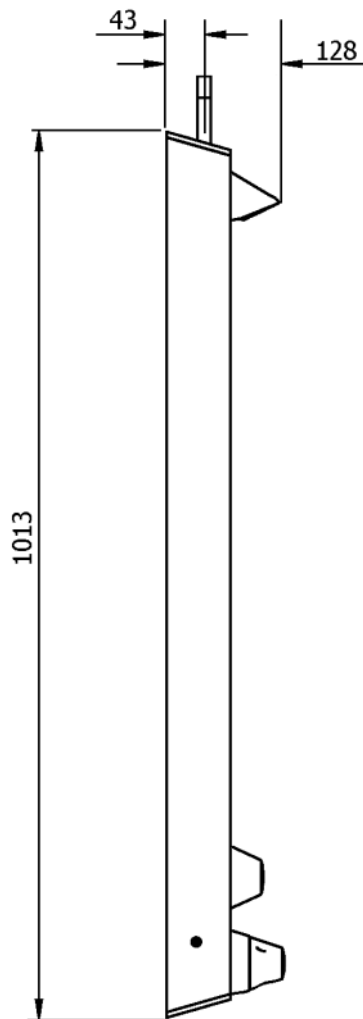

The T113ALR shower panel is pre-plumbed with an integral thermostatic mixing valve, which features:

- Low level isolating servicing valves
- Integral fine mesh strainers, which provide essential protection to the internal mechanism of the valve and ancillary fittings
- Angle pattern inlets enable easy access to the strainers
- Integral check valves prevent cross migration of water supplies
- Flushing facility to allow water supplies to be flushed clean during commissioning and for routine system maintenance

Operating Conditions:

- Mixed water temperature preset to 41°C
- Range of hot water supply temperature: 52 – 85°C
- Maximum static pressure: 10 bar
- Minimum differential between hot water and mixed water temperatures: 5°C
- Range of maintained water supply pressures: 0.5 – 5 bar

Hot and cold water pressures do not need to be equal. The lower of the two pressures, however, should not be less than 0.5 bar maintained at the shower head.